

# Professional Digital audio processor

## DP4080

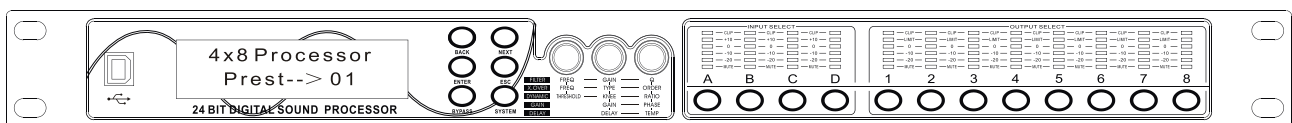

## Safety Guide

---

Please read the instructions carefully before using this device, and adhere to the operation and use of key word, this manual shall be properly kept for later use.

- ◆ Power supply: this device can only use manual along with the types of power supply.
- ◆ The power line protection: to pay attention to avoid the power cord is squeezed by heavy objects, special attention should be paid to the power cord plugs, device to qualify and party  
Then plug in, avoid by all means, take the power cord.
- ◆ Shuikou moisture: cannot be used in closer from the water source place, such as: bath crock, XiShuChi, kitchen sink, sink the damp  
The place such as the basement, swimming pool, otherwise you will have the possibility of suffering from electric shock.
- ◆ Temperature: this device must be far away from heat source. For example, radiator, heat resistance, all kinds of stoves and other heating device (including amplification).
- ◆ Shock: must pay attention to prevent goods or flow into inner core. If falling into metal or other conductive objects, the inner causes Electric shock risk of short circuit.
- ◆ Fire: cannot put vase or other containers of liquid in the machine, otherwise the liquid could be produced within the flow into the machine Short circuit and cause a fire.
- ◆ Cover plate disassembly: due to machine memory with high pressure, the electronic professional and technical personnel, do not remove the chassis, if internal electronic parts were not positive Often contact, serious electric shock accident may happen. The company is not responsible for this event.
- ◆ Cleaning: do not use volatile solution. Such as: alcohol, paint thinner, gasoline, naphtha, etc to wipe the shell, use cleanDry cloth.
- ◆ Abnormal smell: when found abnormal smell or smoke, shall be immediately cut off and pull out the power plug, or recent maintenance department and suppliersDoor contact, for maintenance services.
- ◆ When idle for a long time:
  - A. To be on the safe side, please cut off the power switch, pull the plug. In case of fire.
  - B. To prevent fall into water, metal, inflammable or other foreign material inside the machine, so as to avoid electric shock and fire accidents. In case of such accident Please immediately cut off the power and stop using it. And contact the company service center or where to buy stores, for maintenance service.
- ◆ Note: do not press the plug below the machine or sandwiched between other items; Don't make the exchange of personnel in frequent power supply Place, in order to avoid electric shock or fire accident caused by plug damage.
- ◆ Use: please switch machine in a reasonable sequence; Boot: open before class first, then open the power amplifier; Shutdown: first close amplifiers, after the former level.



This series of products are professional equipments. The output connection mode and voltage are different from those of individual products. So it is very important to operate strictly according to our instructions when you connect machine power or connect to other devices. Otherwise serious risks might occur.



This series of products are professional equipments that have HV electrified parts inside. Any unqualified personnel without the full professional training should not attempt to open or repair the machine. He may risk his life by getting electric shock.

---

Cover and back.....	Safety Guide
Signs description.....	03
Risks and warning.....	04
To the customer.....	05
Features and maintenance.....	06
Introduction of the front panel functions .....	07
Introduction of the rear panel functions and connections.....	08
System operation method.....	09
Transformation configuration for 4 input and 8 output.....	14
Transformation configuration for 3 input and 6 output.....	16
Product technical specifications.....	18
Pc control interface installation and group network connection.....	19
Pc control interface thumbnail.....	20

## Signs Description



This equipment is only useable in non-tropical regions.



This equipment is only useable in regions below 2000m altitude above the sea level.



This equipment is recyclable. Don't discard.



This equipment is fit for indoor use only.



A sign of high voltage and electricity hazard.



A sign of Caution.



A sign of the product's safe grounding.

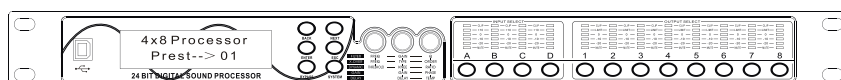

## WARNING

TO REDUCE THE RISK OF ELECTRIC SHOCK, DO NOT EXPOSE EQUIPMENT TO RAIN OR MOISTURE. DO NOT REMOVE COVER. NO USER SERVICEABLE PARTS INSIDE. REFER SERVICING TO QUALIFIED SERVICE PERSONNEL.

## WARNING

TO REDUCE THE RISK OF ELECTRIC SHOCK, DO NOT EXPOSE THIS EQUIPMENT TO RAIN OR MOISTURE.



### CAUTION

RISK OF ELECTRIC SHOCK  
DO NOT OPEN



### CAUTION

TO REDUCE THE RISK OF  
FIRE REPLACE DXF ONLY WITH SAME  
TYPE FUSE.

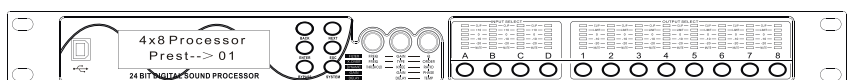



Dear customer,

Thank you for using this product! In order to ensure your and the machine's safety, as well as that you can fully enjoy the best sound effect, please read the instructions in this manual carefully before you start to connect and operate. Please keep this manual properly for future reference.

The open-package inspection:

- ◆ Firstly please check whether the machine has any damage in shipping, then follow the instructions in this manual to connect your machine and test each function. If there are any problems, please inform the sales department.
- ◆ Examine carefully to ensure that the bar code on the rear of the chassis is intact and standard accessories are complete. Machines which were opened by unauthorized departments are not covered by the warranty.
- ◆ It's suggested that you keep the packaging and accessories for later use when transporting or maintenance.



This series of products are professional equipments. The output connection mode and voltage are different from those of individual use. So it is very important to operate strictly according to our instructions when you connect machine power or connect to other devices, otherwise serious risks might occur.



This series of products are professional equipments that have HV electrified parts inside. Any unqualified personnel without the full professional training should not attempt to open or repair the machine. He may risk his life by getting electric shock.

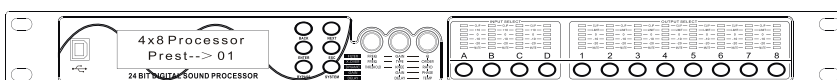

## Product features and maintenance

---

### Product features

This product is a 1 u rack type programmed 4 input/8output 24-bit digital audio processor . The programming is operated through the front panel and a 2 x20 characters display, with a very intuitive and a user-friendly interface. The Pc system software can be used via a PC platform. This product is more than a frequency divider. It can also provide signal distribution, gain control, balance, delay and amplitude limit. In a word, this product is a powerful machine which can be used for fixed installation or in live performances. Each input channel is equipped with six parametric equalizer, each output channel is equipped with six parametric equalizer, + 20 db gain and - 20 db decay. The bandwidth is from 0.05 oct to 3.0 oct.

- ◆ 4 channels signal input, 8 channels signal output
- ◆ 96 KHZ sampling frequency.
- ◆ 24 bits high performance analog-digital converter, the fastest 32 bit floating point computing chip is adopted
- ◆ Each input channel is equipped with six parametric equalizer, each output channel is equipped with six parametric equalizer, + 15 db gain and - 30 db decay. The bandwidth is from 0.05 oct to 3.0 oct.
- ◆ Each input and output channel is with mute function editing button.
- ◆ Delay time can be adjusted using milliseconds as the unit of time, from 0 to 1000 ms, convenient calculation.
- ◆ 30 programmes can be stored
- ◆ Password can be set to protect the program..
- ◆ Compression function is provided. You can adjust starting attack and release times independently.
- ◆ 2 lines of 20 characters LCD display.
- ◆ Output channel can be freely chosen, there are A, B, C, D four patterns of output. Each output is with +15 db and - 30 db gain.
- ◆ Each channel is with phase selection, namely the positive and negative phase.
- ◆ Many kinds of high and low pass filter and the slope can be chosen from.

### Maintenance

---

A: when the device needs to be cleaned, please use dry cloth to wipe the dirt. If the machine is very dirty, you may use a dry cloth and take some cleaning solution, soak them in a container for 3-5 seconds. Take it out to clean the machine and then use a dry cloth to wipe the machine.

B: do not use alcohol, dissolving liquid, pesticides or other volatile or corrosive liquid to clean the case, for these material can do harm to the machine surface . Also do not lay it idle for long time or use chemical fabrics to clean the surface for eventually they may cause fade or fall off of the machine surface. In case cleaning agents are needed please carefully read the descriptions of them before use.

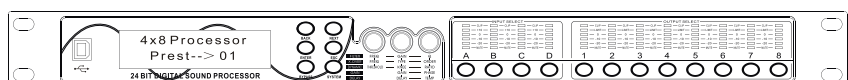

# Introduction of the front panel functions

**Back**

To page up or move the cursor when edit

**USB interface**

Use a USB cable to connect the machine and PC

**LED display**

Turn on the power supply, display light can display various parameters for user's convenience

**Enter**

Confirm the parameter you are setting or enter into operation menu

**Bypass**

Choose to open or close when editing EQ. Adjusted parameter is not implemented under bypass condition.

**Next**

To page down or move the cursor when edit

**ESC**

Back to previous menu when click ESC in edit state or return to stand-by under other conditons

**System**

In standby state, press this key to enter the system setup program, such as: programming (load, save, delete programs); safety lock (lock, unlock); system settings (display light time setting, network ID setting, view the system information ), etc

**FREQ edit knob**

To adjust Frequency or set other parameters in edit state

**GAIN edit knob**

To adjust Gain or set other parameters in edit state

**Q Value edit knob**

To adjust Q Value or set other parameters in edit state

**Input channel setting key**

Click this key to make current channel MUTE or Sound On.  
Push this key 3 seconds to enter into this channel's setting mode

**Output channel setting key**

Click this key to make current channel MUTE or Sound On.  
Push this key 3 seconds to enter into this channel's setting mode

**Signal indicator**

To indicate the output level , Mute and Edit state

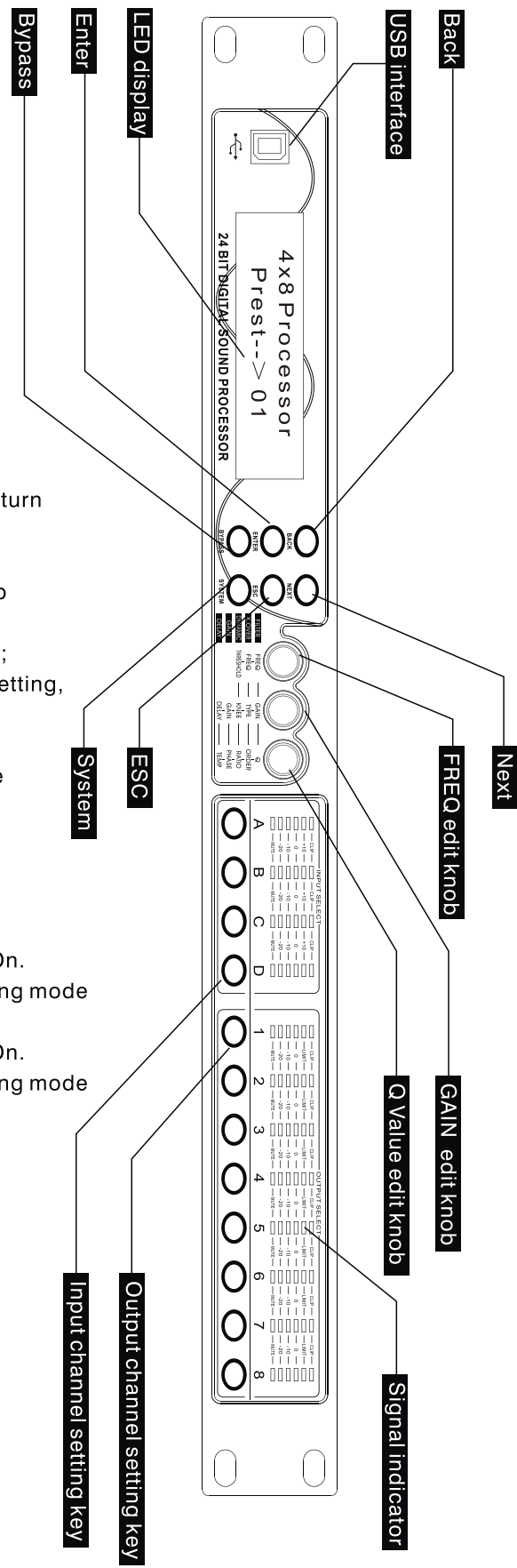

Note: Push ESC and return to stand-by interface during setting procedure

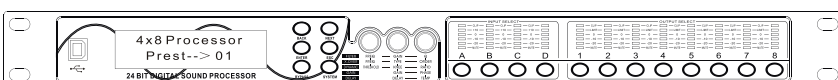

# Introduction of the rear panel functions

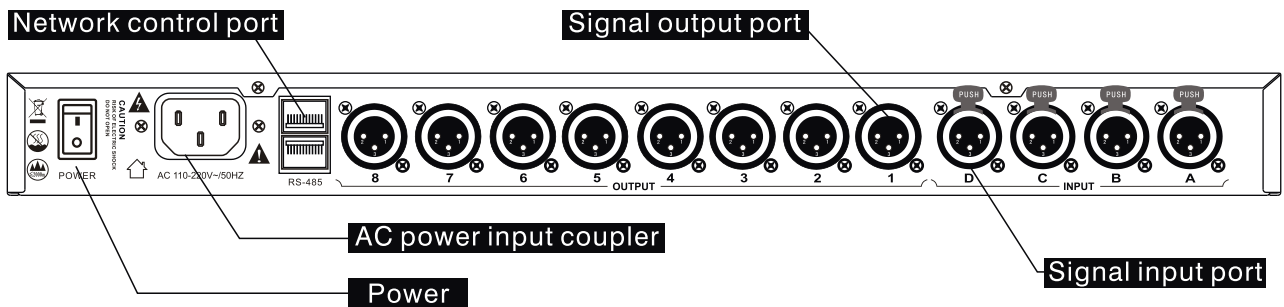

### Power

To switch on/off the power supply

### AC power input coupler

To connect to the AC power grid. Please make sure that the power supply meets the requirement of the machine as well as a reliable connection.

### Network control port

To form network communication with an ordinary cable. Set different ID for each machine and then you can exercise network group management through one machine which has been connected to a PC.

### Signal output port

This port is used to connect the input terminal of a power amplifier. Whether this channel's output signal is needed can be set by a PC or panel operation. Also can set the relationship with the input signal.

### Signal input port

This port is used to connect the output terminal of a power amplifier. Whether this channel's output signal is needed can be set by a PC or panel operation. Also can set the relationship with the output signal.

## Connection



Shielded wire with three cores

### Instructions of bonding balanced input connectors:

These cables can be used in balance and imbalance input and imbalance output signal transmission.

Instruction of polarity connection is as the diagram to the right

The connector is for every XLR balance output.

The connector can be connected to input terminal of a power amplifier.

Note: Balanced XLR can also be used in imbalanced connector. But the third pin must not be used, the first pin and the case must be connected to ground correctly. When using balanced connector, three terminals (stereo) connection should use correct connection method and ensure every pins' connection. Make sure a safe and reliable ground connection. Incorrect connection may cause about 6 db signal loss.

### Connecting pins bitmap

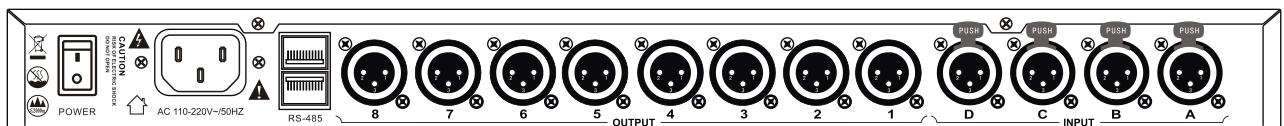
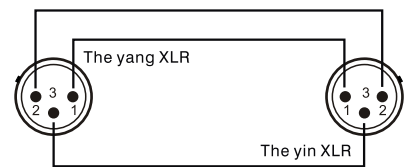
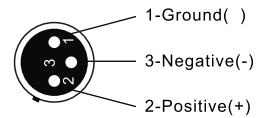

### Notes about connection:

1. Minimize all volume control before the connection.
2. Before plug in the power plug, make sure the power supply meets the requirement of this machine.
3. Pull out the plug before replacing a fuse. Always use the correct fuse that has the right specifications.
4. Connect directly each output terminal to input terminal of a power amplifier.

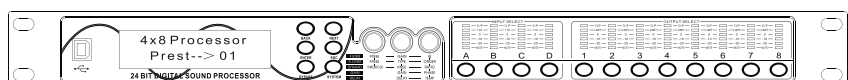

## 一、Set input A

Notice: Click ESC to quit and back to standby interface  
Display screen is as below when the power is on



### 1. Gain settings



Click and hold input channel A key for about 2 seconds. Light up -20 signal light and MUTE light at the same time and enter into GAIN settings. Rotate FREQ knob to set parameters. (Parameters can be chosen from -40dB to +12dB)

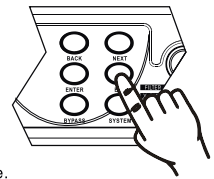

Press this key to return to previous menu during the setting processing. If there's no previous menu then return to standby interface.

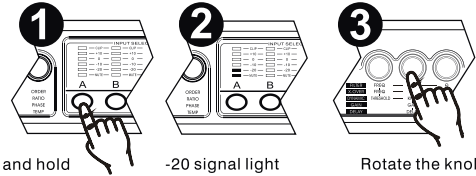

Click and hold this key for about 2 seconds.

-20 signal light and MUTE light are lit up simultaneously.

Rotate the knob to set Gain parameters.

### 2. Delay settings



Click and hold input channel A key for about 2 seconds. Light up -20 signal light and MUTE light at the same time and enter into settings and then click page down to DELAY settings. Rotate FREQ knob to set parameters. (Parameters can be chosen from 0ms to 1000ms)

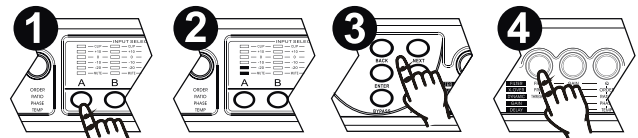

Click and hold this key for about 2 seconds.

-20 signal light and MUTE light are lit up simultaneously.

Click page up or page down to DELAY item.

Rotate the knob to set DELAY parameters.

### 3. EQ1 ( Equalizer settings)



Click and hold input channel A key for about 2 seconds. Light up -20 signal light and MUTE light at the same time and enter into settings and then click page up and page down to EQ1 settings. Rotate FREQ knob or Q knob and set filter type. (Parameters include PEQ, LS6, LS12, HS6, HS12). Press BYPASS key to open or close current EQ effects. Press ENTER key to enter settings of current EQ frequency, Gain, and Q Value. Rotate FREQ knob and set frequency parameters. Rotate GAIN knob and set gain parameters and rotate Q knob and set Q Value parameters..

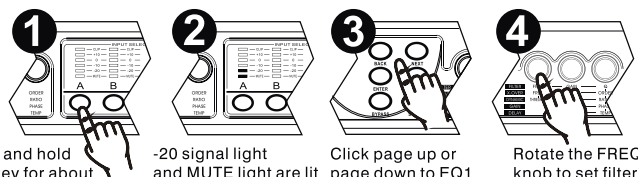

Click and hold this key for about 2 seconds.

-20 signal light and MUTE light are lit up simultaneously.

Click page up or page down to EQ1 item.

Rotate the FREQ knob to set filter type.

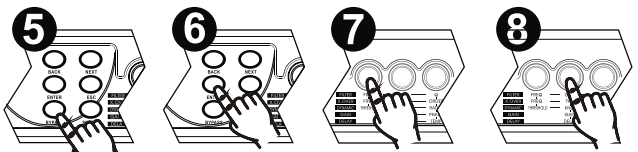

Click BYPASS to open or close current EQ.

Enter

Rotate the FREQ knob to set frequency.

Rotate the GAIN knob to set gain.



Note: The parameters come to work only when the EQ is on



Rotate the Q knob to set Q Value.

### 4. EQ2 to EQ6 settings

Setting method of EQ2 to EQ6 is the same as that of EQ1. Please make reference of EQ1 setting instruction. Setting method of other channels is the same as that of INPUT A. Please follow INPUT A setting steps.

## 二、Set OUTPUT 1

Notice: Press ESC to quit and back to standby interface

### 1. Gain settings

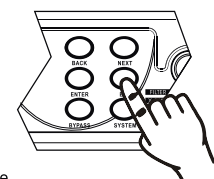
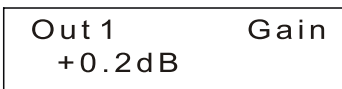

Press this key to return to previous menu during the setting processing. If there's no previous menu then return to standby interface.

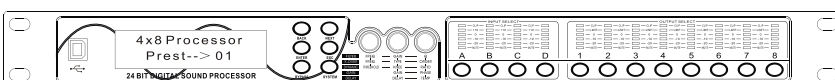

# System operation

Click and hold Output channel 1 key for about 2 seconds.  
 -20 signal light and MUTE light are lit up simultaneously and enter into GAIN settings. Rotate FREQ knob to set parameters. (Parameters can be chosen from -40dB to +12dB)

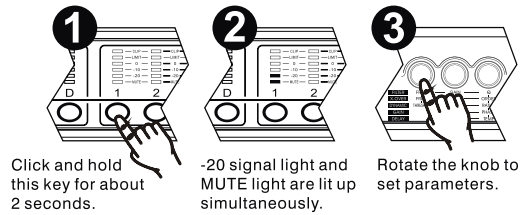

## 2.Set relationships of current output channel and input source

Out 1	Source
B	

Click and hold output channel 1 key for about 2 seconds. Light up -20 signal light and MUTE light at the same time and enter into settings and then click page down to SOURCE settings. Rotate FREQ knob to set input channel parameters.. (Parameters can be chosen from A, B, C, D, SUM A+B, SUM C+D, ALL, OFF)

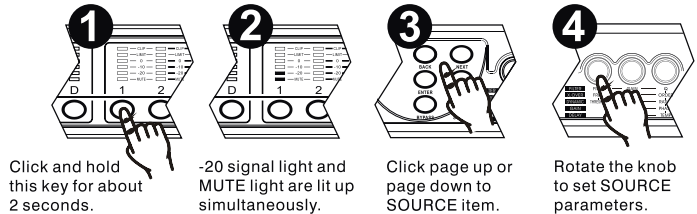

## 3.DELAY Settings:

Out1	DELAY	0.00ms
	0.00m	0.00ft

Click and hold output channel 1 key for about 2 seconds. Light up -20 signal light and MUTE light at the same time and enter into settings and then click page down to DELAY settings. Rotate FREQ knob to set parameters. (Parameters can be chosen from 0ms to 1000ms)

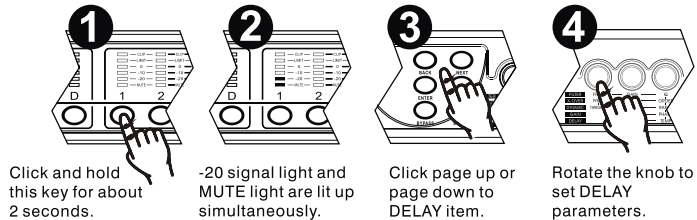

## 4.Polarity Settings:

Out1	Polarity
+ Normal	

Click and hold output channel 1 key for about 2 seconds. Light up -20 signal light and MUTE light at the same time and enter into settings and then click page down to Polarity settings. Rotate FREQ knob to set parameters. (Parameters are optional from -Invert and + Normal)

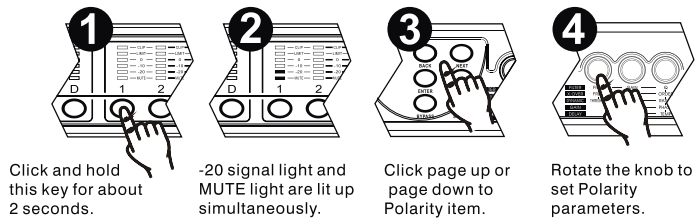

## 5.HPF Settings:

Out1	HPF
29.5Hz	24dB-Bessel

Click and hold output channel 1 key for about 2 seconds. Light up -20 signal light and MUTE light at the same time and enter into settings and then click page down to HPF (high pass filter) settings. Rotate FREQ knob to set frequency. (Parameters are optional from OFF, 19.7Hz to 21.9 Hz). Rotate Gain knob to set filter slope. (Parameters are ranging from 12db-Bworth, 12db-Bessel, 12db-Lnkwtz, 18db-Bworth, 18db-Bessel, 24db-Bworth, 24db-Bessel, 24db-Lnkwtz, 48db-Bworth, 48db-Bessel, and 48db-Lnkwtz)

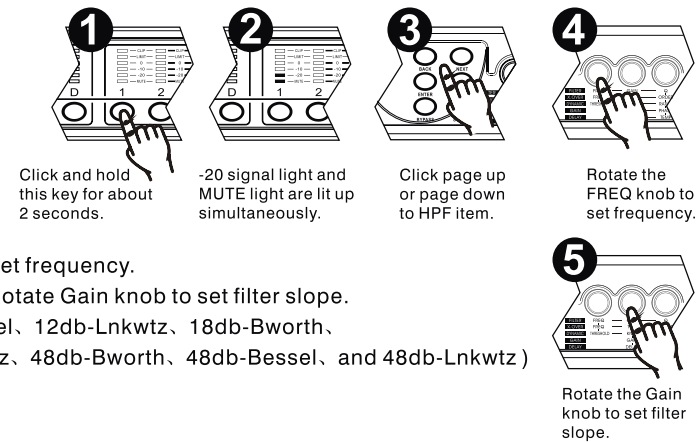

## 6.LPF Settings:

Out1	LPF
19k5Hz	24dB-Bessel

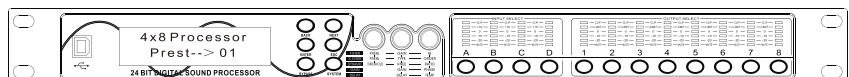



Click and hold output channel 1 key for about 2 seconds. Light up -20 signal light and MUTE light at the same time and enter into settings and then click page down to HPF (high pass filter) settings. Rotate FREQ knob to set frequency. (Parameters are optional from OFF, 19.7Hz to 21.9 Hz). Rotate Gain knob to set filter slope. (Parameters are ranging from 12db-Bworth, 12db-Bessel, 12db-Lnkwtz, 18db-Bworth, 24db-Bworth, 24db-Bessel, 24db-Lnkwtz, 48db-Bworth, 48db-Bessel, and 48db-Lnkwtz )

## 7. EQ1 (Equalizer) settings

Oot1	OFF	EQ 1
PEQ		

Click and hold Output channel 1 key for about 2 seconds. Light up -20 signal light and MUTE light at the same time and enter into settings interface and then click page up and page down to EQ1 settings. Rotate FREQ knob or Q knob and set filter type. (Parameters include PEQ, LS6, LS12, HS6, HS12). Press BYPASS key to open or close current EQ effects. Press ENTER key to enter settings of current EQ frequency, Gain, and Q Value. Rotate FREQ knob and set frequency parameters. Rotate GAIN knob and set gain parameters and rotate Q knob and set Q Value parameters..



Note: The parameters come to work only when the EQ is on

## 8. EQ2 to EQ6 settings

Setting method of EQ2 to EQ6 is the same as that of EQ1. Please refer to the EQ1 setting instruction.

## 9. LIMITER settings

Oot1	Limit	+18dBu
A0.5ms		R50ms

Click and hold Output channel 1 key for about 2 seconds. Light up -20 signal light and MUTE light at the same time and enter into settings interface and then click page up and page down to Limit (pressure limit) settings. Rotate FREQ knob and set pressure limit parameters (Parameters are ranging from -20dB to +20dB). Rotate GAIN knob to set the starting time ( Parameters are ranging from 0.5ms to 50ms). Rotate Q knob to set release time (Parameters are ranging from 10ms to 1sms).

Setting method of other output channels is the same as that of OUTPUT1. Please follow the steps.

## 三、System settings

Click SYSTEM key to enter SYSTEM settings page. Click page up or page down to select setting items and click ENTER to confirm the choice. Rotate FREQ knob , GAIN knob and Q knob to set parameters.

### 1. The Main Menu Xover Submenu programming settings

《Main Menu》
Xover Submenu

Click this key to enter system settings

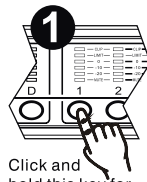
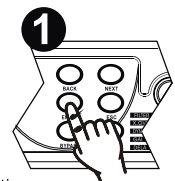

1 Click and hold this key for about 2 seconds.

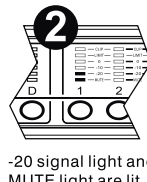

2 -20 signal light and MUTE light are lit up simultaneously.



3 Click page up or page down to LPF item.



4 Rotate the FREQ knob to set frequency.

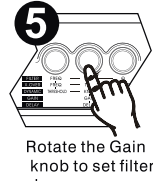

5 Rotate the Gain knob to set filter slope.

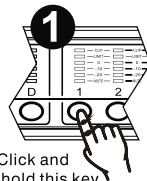

1 Click and hold this key for about 2 seconds.

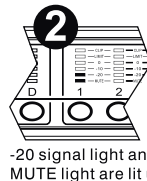

2 -20 signal light and MUTE light are lit up simultaneously.



3 Click page up or page down to EQ1 item.



4 Rotate the FREQ knob to set filter type.



5 Click BYPASS key to open or close current EQ.

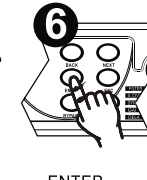

6 ENTER

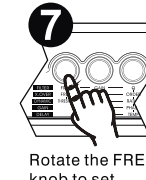

7 Rotate the FREQ knob to set frequency.

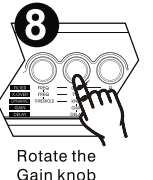

8 Rotate the Gain knob to set gain.

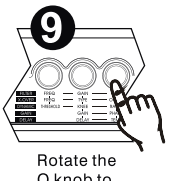

9 Rotate the Q knob to set Q Value..

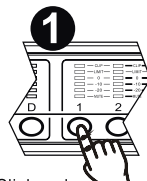

1 Click and hold this key for about 2 seconds.

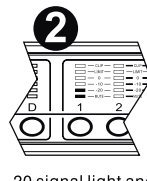

2 -20 signal light and MUTE light are lit up simultaneously.



3 Click page up or page down to Limit item.



4 Rotate the FREQ knob to set pressure limit threshold.

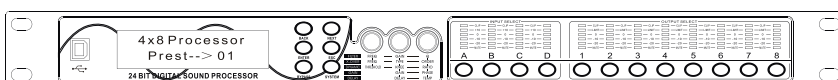

# System operation

## 1.1 Load Program

«Main Menu»  
Load Program

Click SYSTEM key to enter SYSTEM settings page. Click page up or page down to Main Menu Xover Submenu and click ENTER to confirm the choice. Page up or page down to Xover Submenu Load Program and enter. Rotate FREQ knob, GAIN knob and Q knob to set loading programs. (Parameters are optional from 1-30).

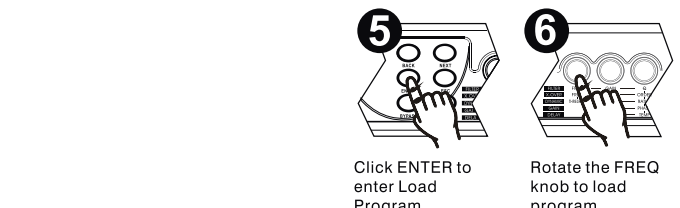
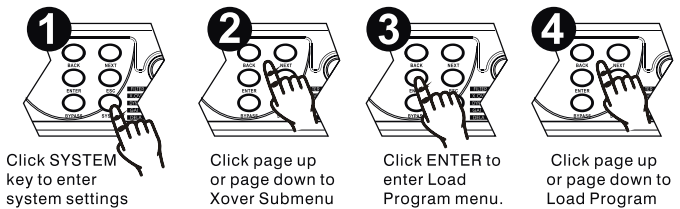

## 1.2. Store Program

«Main Menu»  
Store Program

Click SYSTEM key to enter SYSTEM settings page. Click page up or page down to Main Menu Xover Submenu and click ENTER to confirm the choice. Page up or page down to Xover Submenu Store Program and enter Input Name. Rotate FREQ knob to select store positions. Up to 30 groups (1-30) of programs can be stored. Rotate GAIN knob to move the cursor up and down. Rotate Q knob to customize the Name. The name should be constituted by letter A-Z and number 0-9.

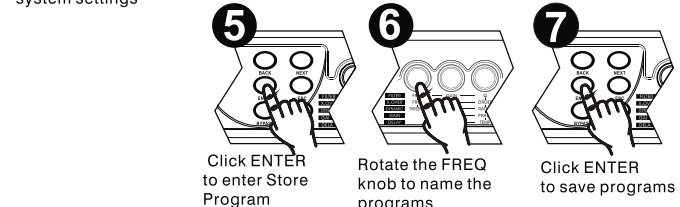
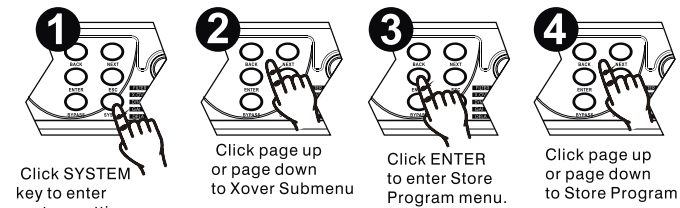

## 1.3. Erase Program

«Main Menu»  
Erase Program

Click SYSTEM key to enter SYSTEM settings page. Click page up or page down to Main Menu Xover Submenu and click ENTER to confirm the choice. Page up or page down to Xover Submenu Erase Program and enter. Rotate FREQ knob to select the preset program name that you want to erase.

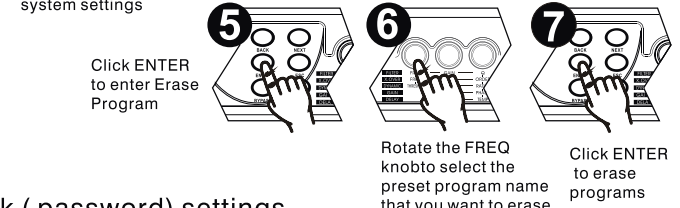
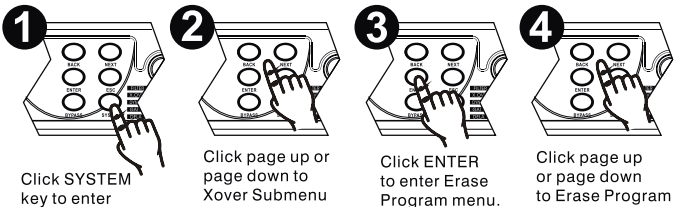

## 2. The Main Menu Security Submenu Safety lock (password) settings

«Main Menu»  
Security Submenu

### 2.1 LOCK

Click SYSTEM key to enter SYSTEM settings page. Click page up or page down to Main Menu Xover Submenu and click ENTER or rotate GAIN knob to set. Rotate GAIN knob to select letter A-Z and number 0-9. Rotate FREQ knob to set the next number. Click ENTER to confirm your password setting. Each key except the SYSTEM key doesn't work now. You should unlock the machine to operate it.

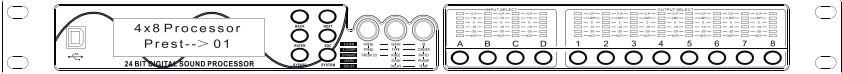
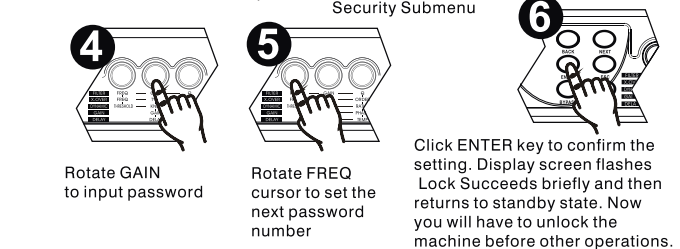
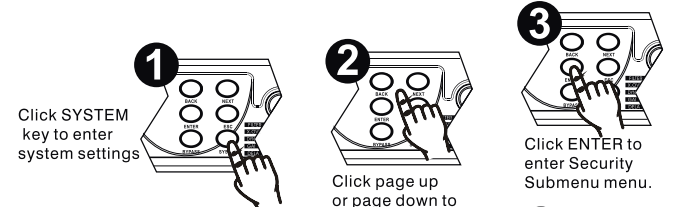





**Note: Password must be constituted by 6 numbers or letters. Remember the password after setting it successfully.**

Unlock

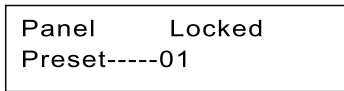

Click SYSTEM key to enter into unlock interface. Rotate GAIN knob to choose from letter A-Z or number 0-9. Rotate FREQ knob to input the next number of password. Click ENTER to confirm your operation after complete all the inputs. Unlock succeeded.

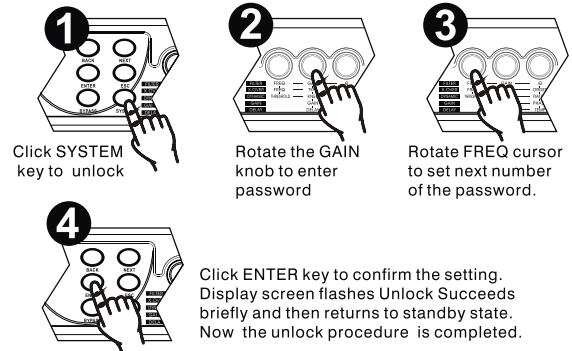

### 3. The Main Menu Security Submenu system settings

#### 3. 1 Display screen backlight time settings

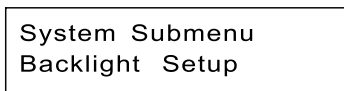

Click SYSTEM key to enter into System setting page. Click page up or page down key to Main Menu System Submenu. Click ENTER and then click page up or page down to System Submenu Backlight Setup item (time setting for display screen backlight). Click ENTER and then rotate FREQ knob, GAIN knob or Q knob to set parameters (You can choose On, or Auto shut after 10 seconds)..

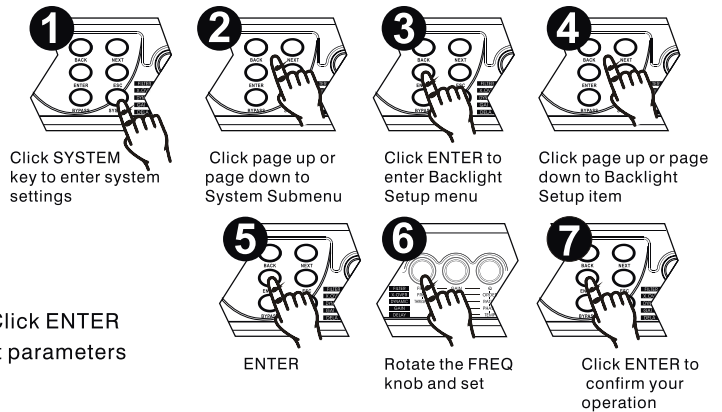

#### 3. 2 Group network ID settings

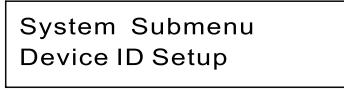

Click SYSTEM key to enter into System setting page. Click page up or page down key to Main Menu System Submenu. Click ENTER and then click page up or page down to System Submenu Device ID Setup item. Click ENTER and then rotate FREQ knob, GAIN knob or Q knob to set parameters (Parameters are optional from 1-250).

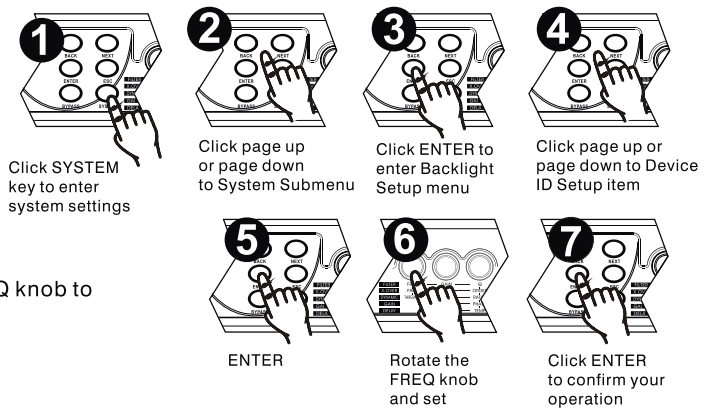

#### 3. 3 View the System Information

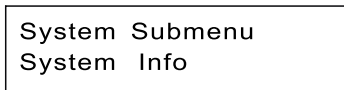

Click SYSTEM key to enter into System setting page. Click page up or page down key to Main Menu System Submenu. Click ENTER and then click page up or page down to System Submenu System Info Setup item. Click ENTER to view the information of the system version.

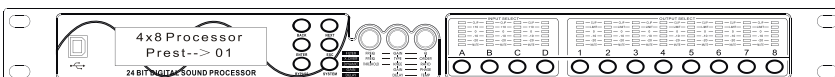
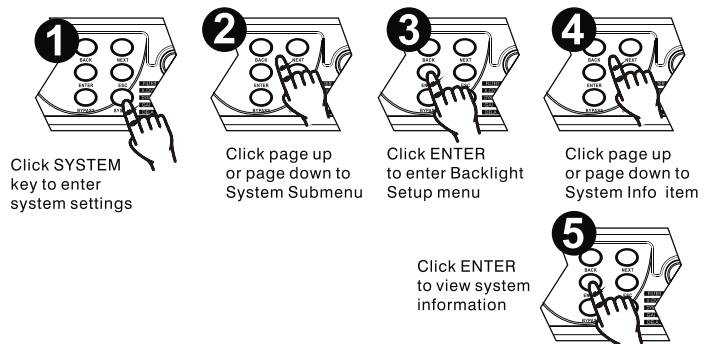

## Transformation configuration for 4 input and 8 output

4 X 2 channels crossover output as shown:

Each input provides a pair of output. The odd number serves as low frequency divider and the even number serves as high frequency divider. The default recommendation is to adopt crossover frequency output method.

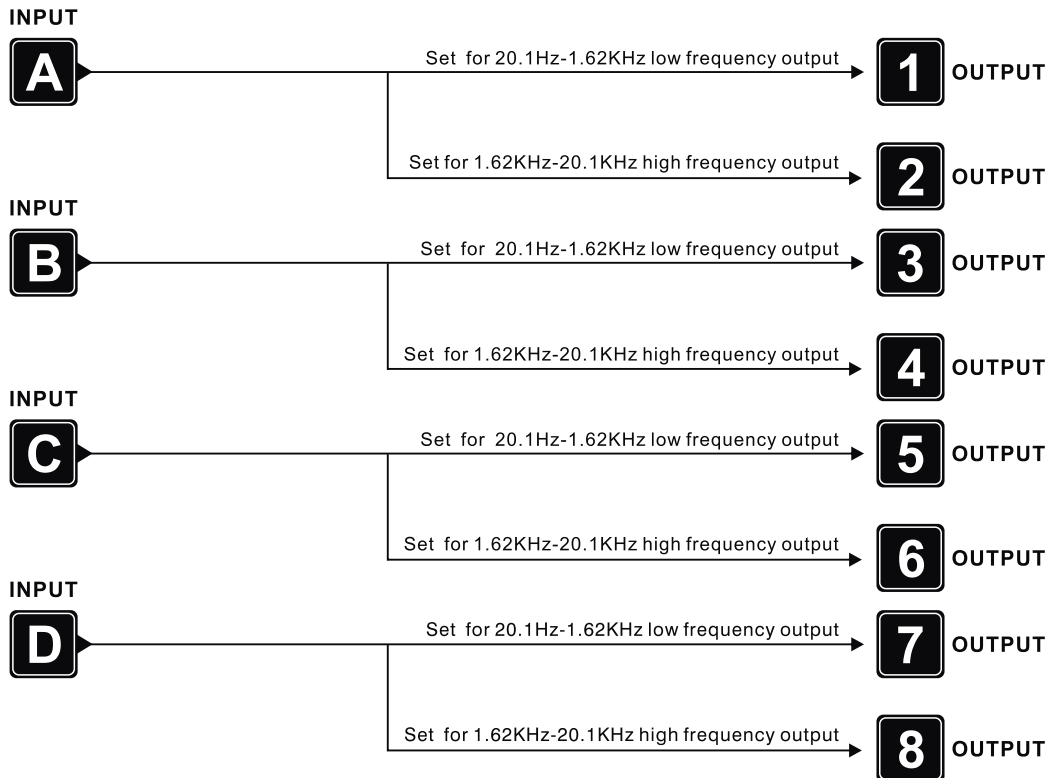

2 X 3 channels cross output as shown:

Set A and B for two channels and three-way output, namely high, medium and low frequency. Set C and D for full-range output. The default recommendation is to adopt crossover frequency output method.

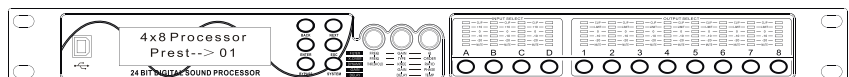
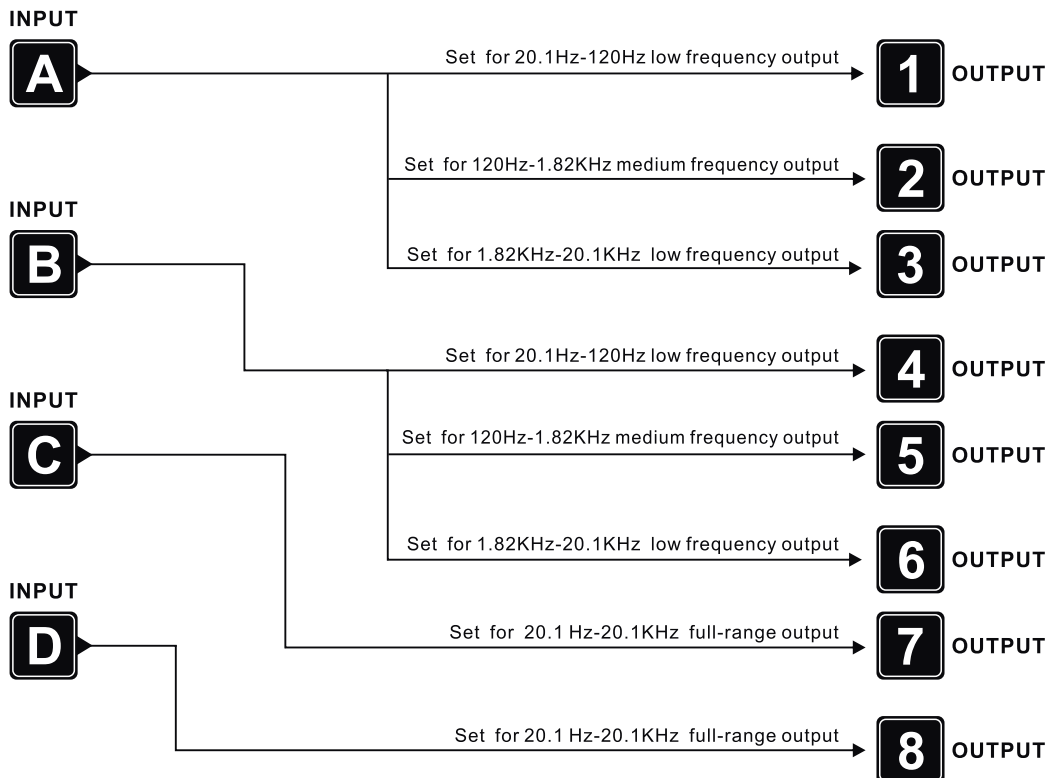

## Transformation configuration for 4 input and 8 output

4 X 2 channels crossover output as shown:

Set A and B for 2 channels 4-way output, namely high, medium high, medium low and low frequency. Set C and D idle. Default recommendation is to adopt crossover frequency output method.

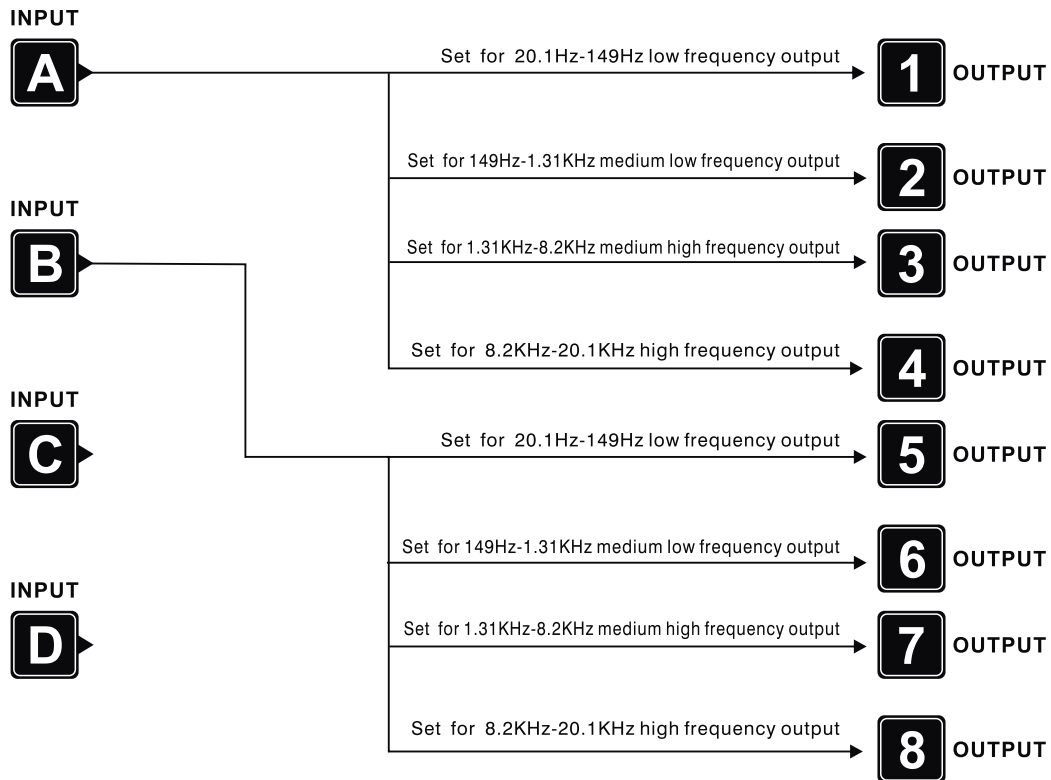

1 X 8 channels crossover output as shown:

Set A for 8 channels full-range output, . Set B,C and D idle. Default recommendation is to adopt crossover frequency output method.

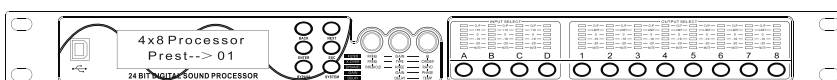
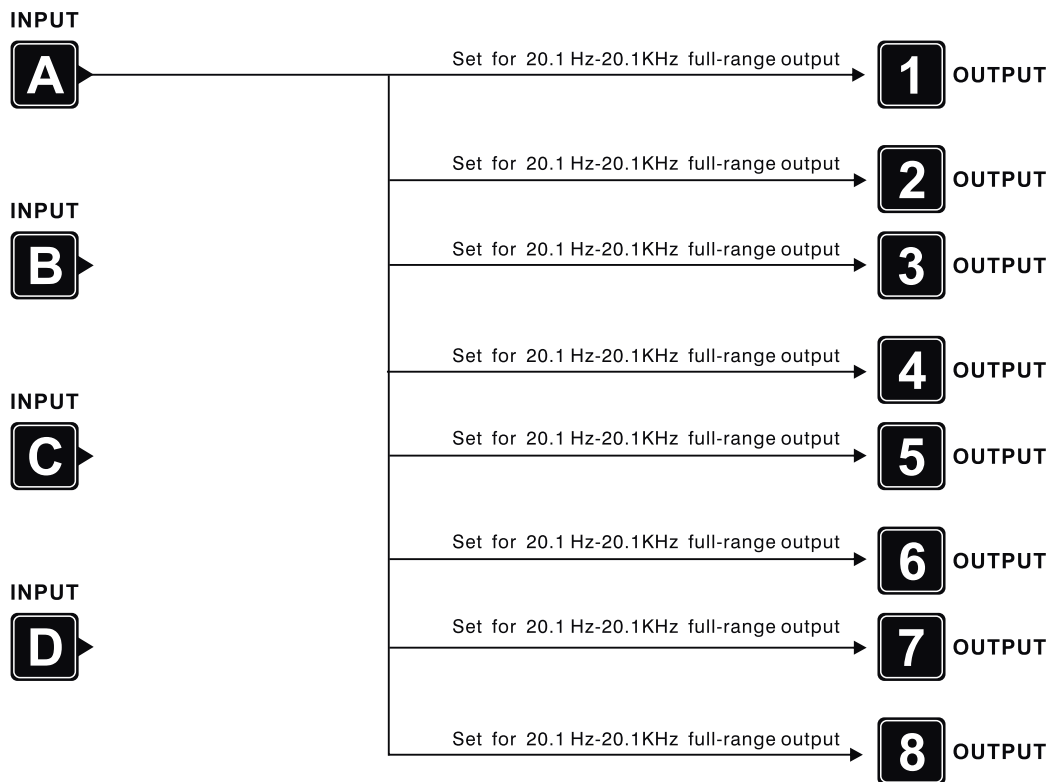

## Transformation configuration for 3 input and 6 output

4 X 2 channels crossover output as shown:

Each input provides a pair of output. The odd number serves as low frequency divider and the even number serves as high frequency divider. The default recommendation is to adopt crossover frequency output method.

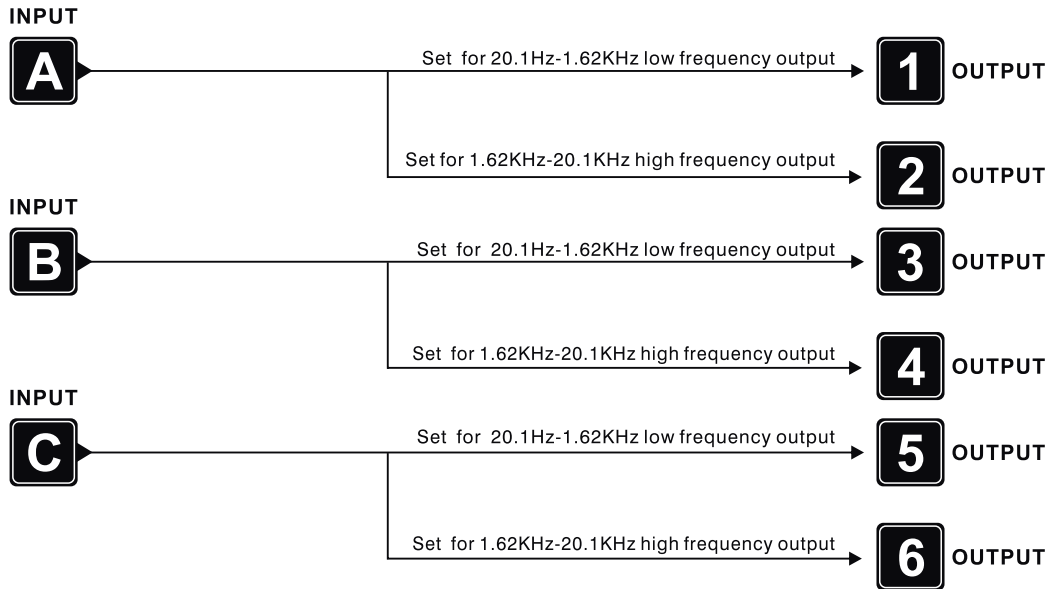

2 X 3 channels cross output as shown:

Set A and B for two channels and three-way output, namely high, medium and low frequency. Set C for full-range output. The default recommendation is to adopt crossover frequency output method.

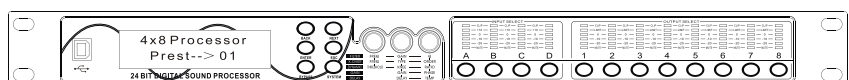
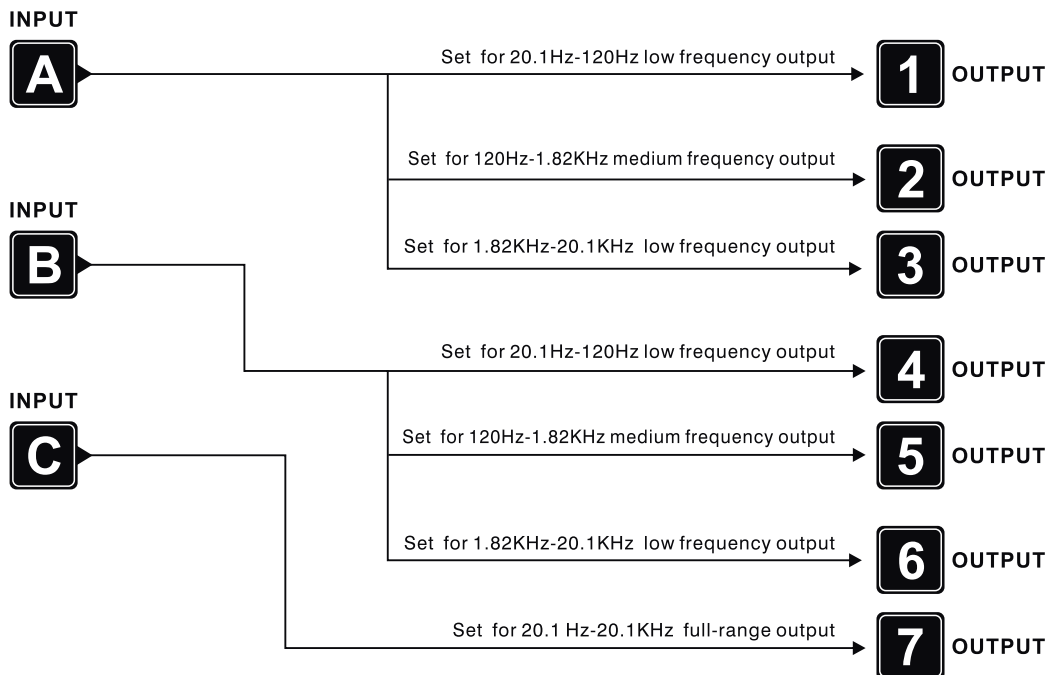

## Transformation configuration for 3 input and 6 output

4 X 2 channels crossover output as shown:

Set A and B for 2 channels 4-way output, namely high, medium high, medium low and low frequency. Set C idle. Default recommendation is to adopt crossover frequency output method.

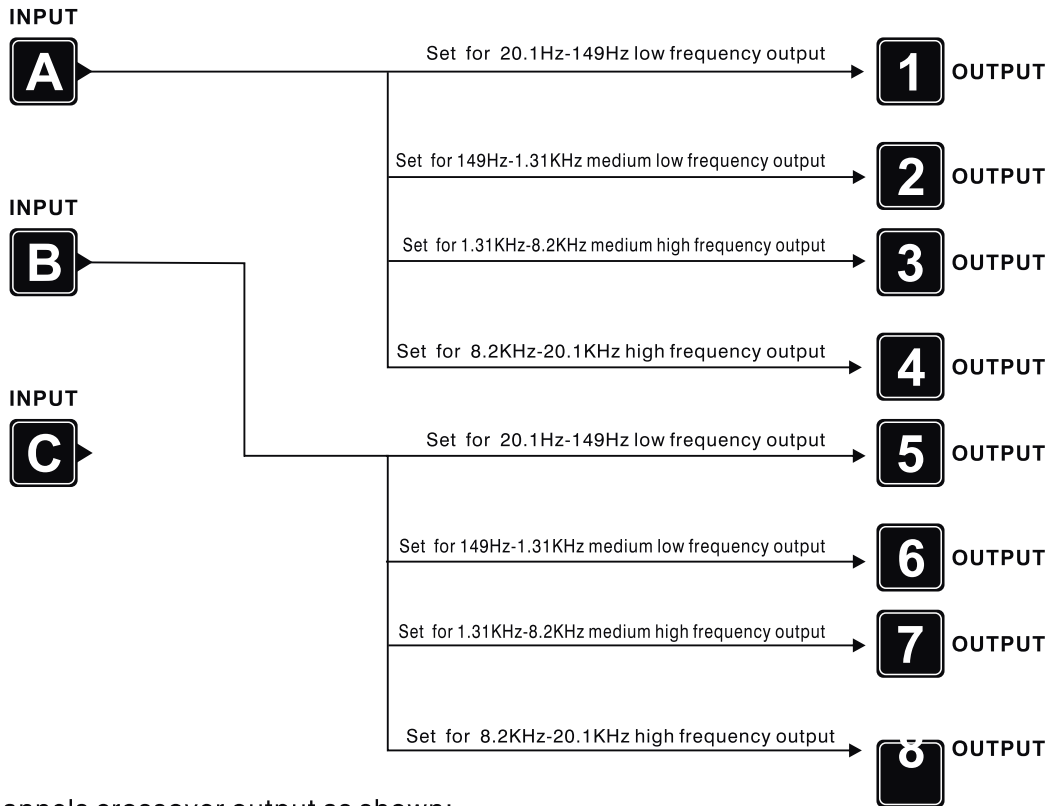

1 X 8 channels crossover output as shown:

Set A for 8 channels full-range output, . Set B,C and D idle. Default recommendation is to adopt crossover frequency output method.

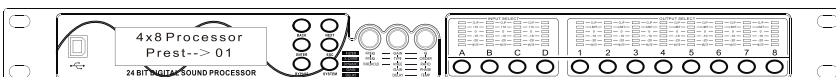
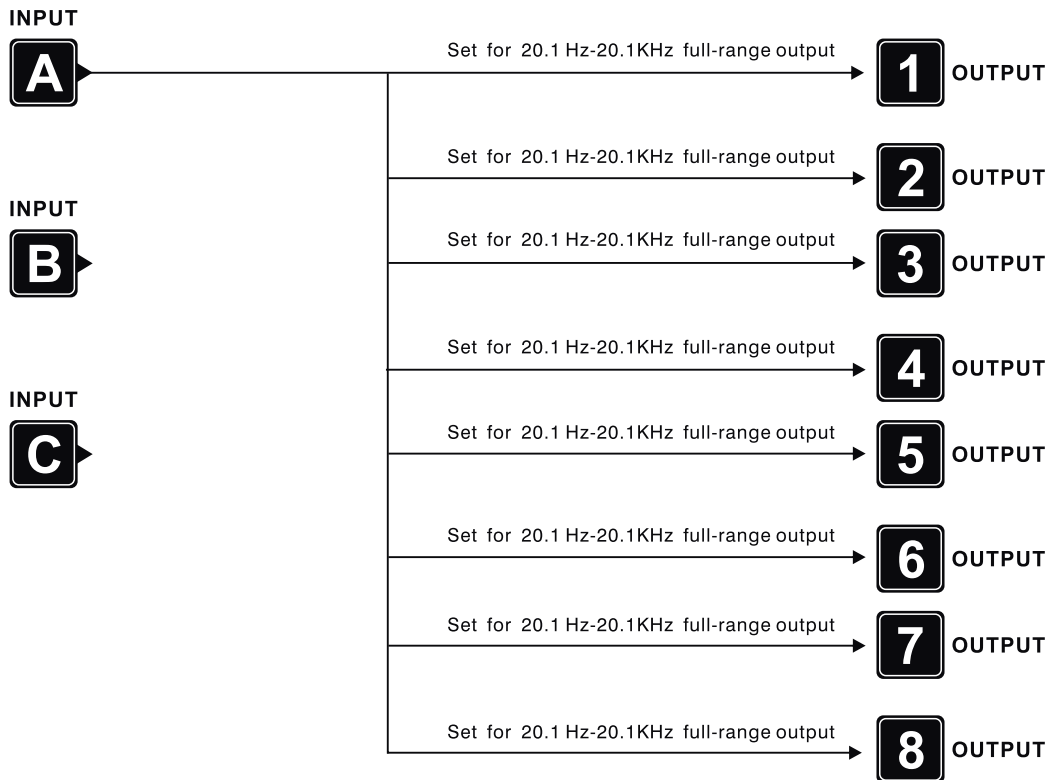

## Product technical specifications

MODEL:	DP4080
Input:	4 channel, 10K ohms balance
Output:	8 channel, 600 ohms balance
PC Com Port:	1 USB Com Port on front panel, 2 RS485 Com Port on back panel (RJ-45)
Processor:	96KHz Sampling frequency, 32-bit Floating-Point DSP, 24-bit A/D and D/A converter
Dynamic range:	>108dB
Frequency Response:	$\pm 0.25$ dB, 15Hz --- 20KHz
Distortion:	< 0.01%, 20Hz - 20KHz @ +10dBu balanced input
Signal to noise ratio:	>110dB
crossover filter:	Each output channel can be independently set as LPF and HPF, The parameters can be adjusted, Filter type:Butterworth, Bessel, Linkwitz-Riley; The Crossover Frequency:20Hz---20KHz, Slope:12,18,24 or 48 dB/octave
EQ:	Bandwidth:0.016 to 4.0 oct, Frequency:20Hz to 20KHz, Gain: -30dB to +15dB, step:0.1 dB
Delay:	0ms to 1000ms
Gain:	-40dB to +12dB
Display:	2 x 20 LCD
Store Settings:	30 user program dynamic storage
Size (H x W x D) :	45 mm x 483 mm x 288 mm
Power supply:	50/60 Hz, 90 - 240V/AC
Power consumption:	< 22 W
Net Weight(kg)	3.3kg
Gross Weight(kg)	4.6kg



Due to a constant product updating, the right to the change of product technical specifications is preserved by the company.

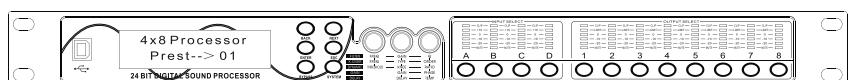

# Instruction for PC control interface installation

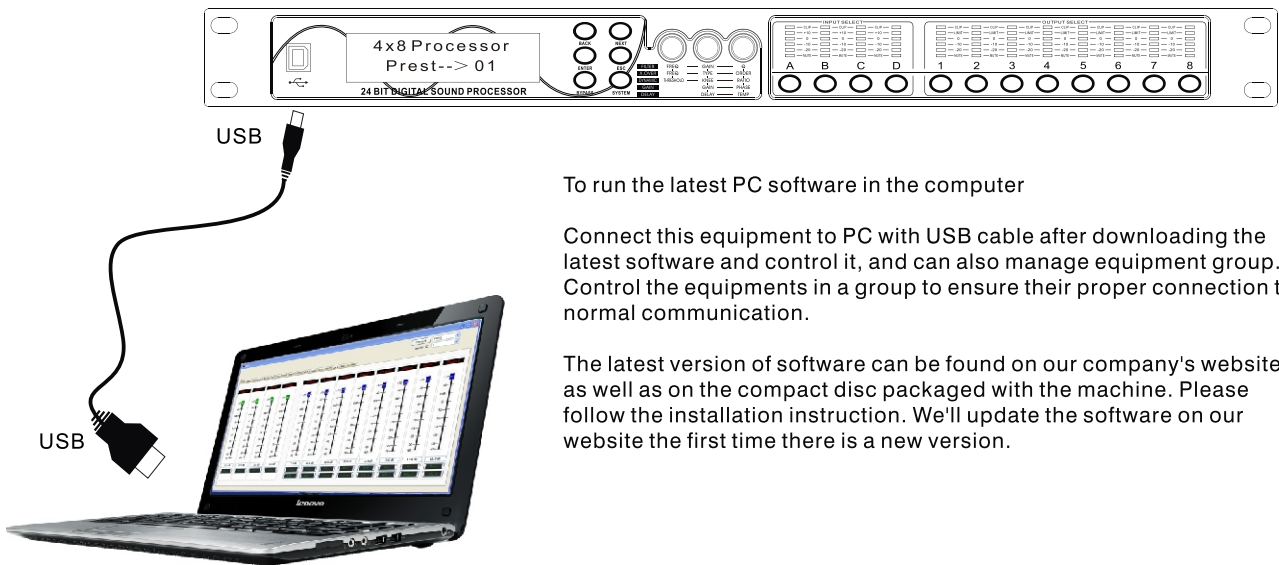

To run the latest PC software in the computer

Connect this equipment to PC with USB cable after downloading the latest software and control it, and can also manage equipment group. Control the equipments in a group to ensure their proper connection to normal communication.

The latest version of software can be found on our company's website as well as on the compact disc packaged with the machine. Please follow the installation instruction. We'll update the software on our website the first time there is a new version.

## Group network connection diagram

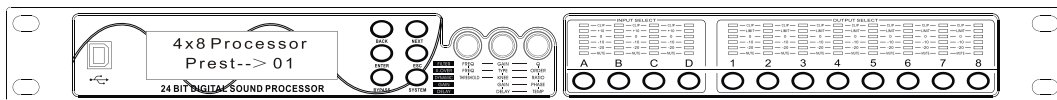

Click SYSTEM key→Click page up/ page down key →"Main Menu" System Submenu item,  
Click ENTER key→System Submenu Device ID Setup item (ID number) Click ENTER key  
→Roate FREQ knob、 GAIN knob、 Q knob enter setting processing Please set it for \*\*ID 1\*\*

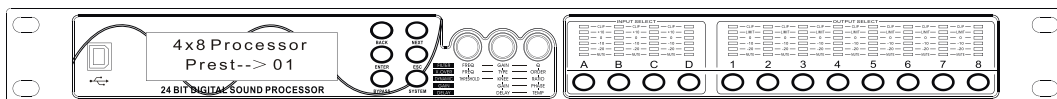
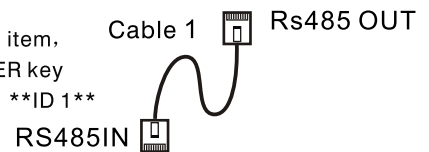

Click SYSTEM key→Click page up/ page down key →"Main Menu" System Submenu item,  
Click ENTER key→System Submenu Device ID Setup item (ID number) Click ENTER key  
→Roate FREQ knob、 GAIN knob、 Q knob enter setting processing Please set it for \*\*ID 2\*\*

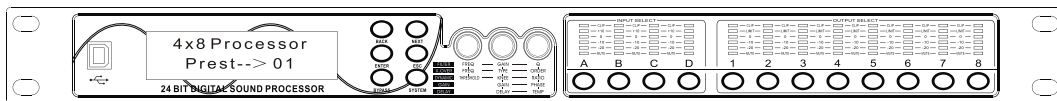
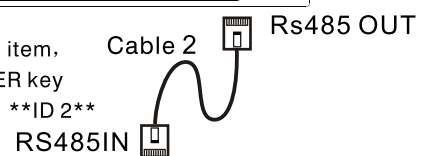

Click SYSTEM key→Click page up/ page down key →"Main Menu" System Submenu item,  
Click ENTER key→System Submenu Device ID Setup item (ID number) Click ENTER key  
→Roate FREQ knob、 GAIN knob、 Q knob enter setting processing Please set it for \*\*ID 3\*\*

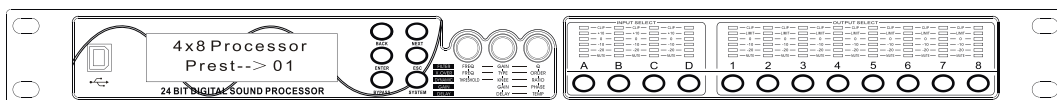
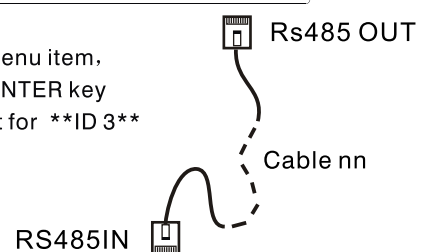

Click SYSTEM key→Click page up/ page down key →"Main Menu" System Submenu item,  
Click ENTER key→System Submenu Device ID Setup item (ID number) Click ENTER key  
→Roate FREQ knob、 GAIN knob、 Q knob enter setting processing Please set it for \*\*ID 250\*\*

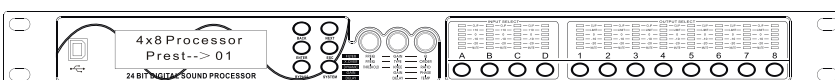

# Instruction for PC control interface installation

## PC control interface thumbnail

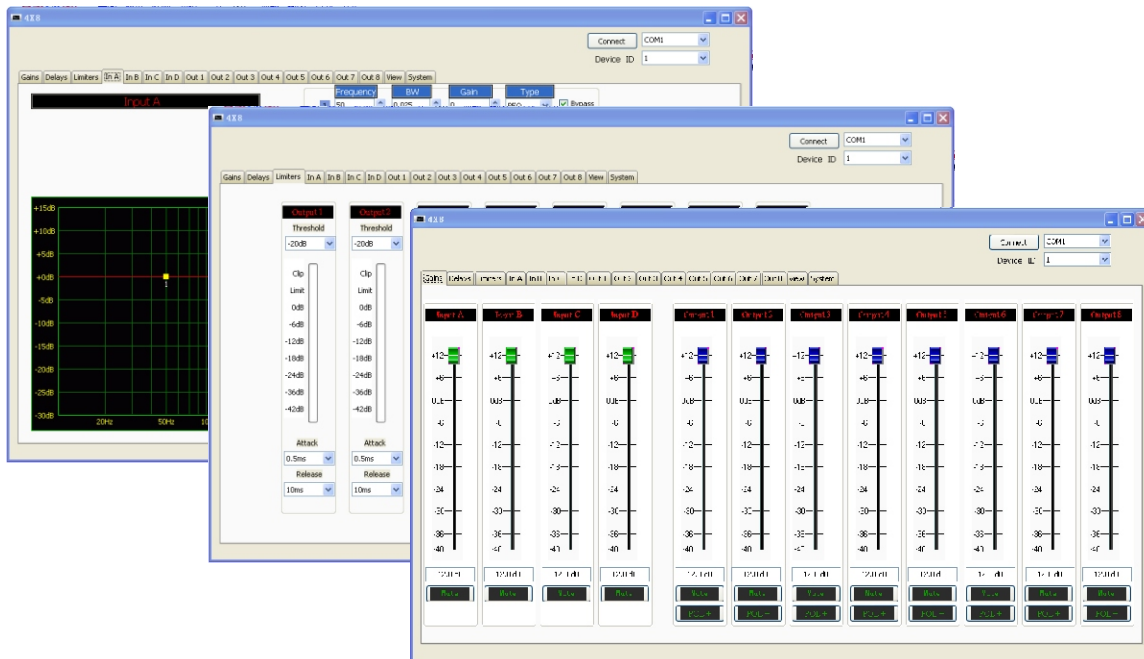
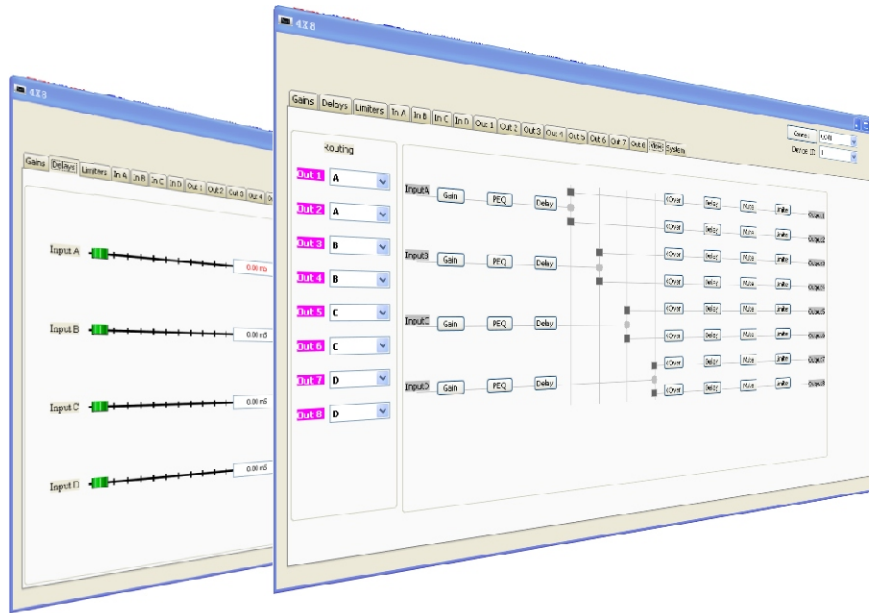

Please refer to instructions for PC control interface installation on the CD.

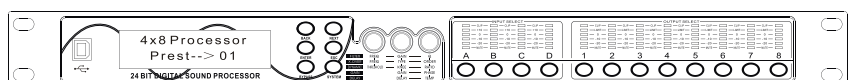





---

# DP4080

Professional Digital audio processor